

29-35 Tranquil Vale, London, SE3 0BU

Application No. DC/21/121861

This presentation forms no part of a planning application
and is for information only.



This is an application for:

Demolition of existing office building (Use Class E) and construction of two three-storey semi-detached houses with associated landscaping to the front and rear of 29-35 Tranquil Vale SE3 with access onto Collins Street.

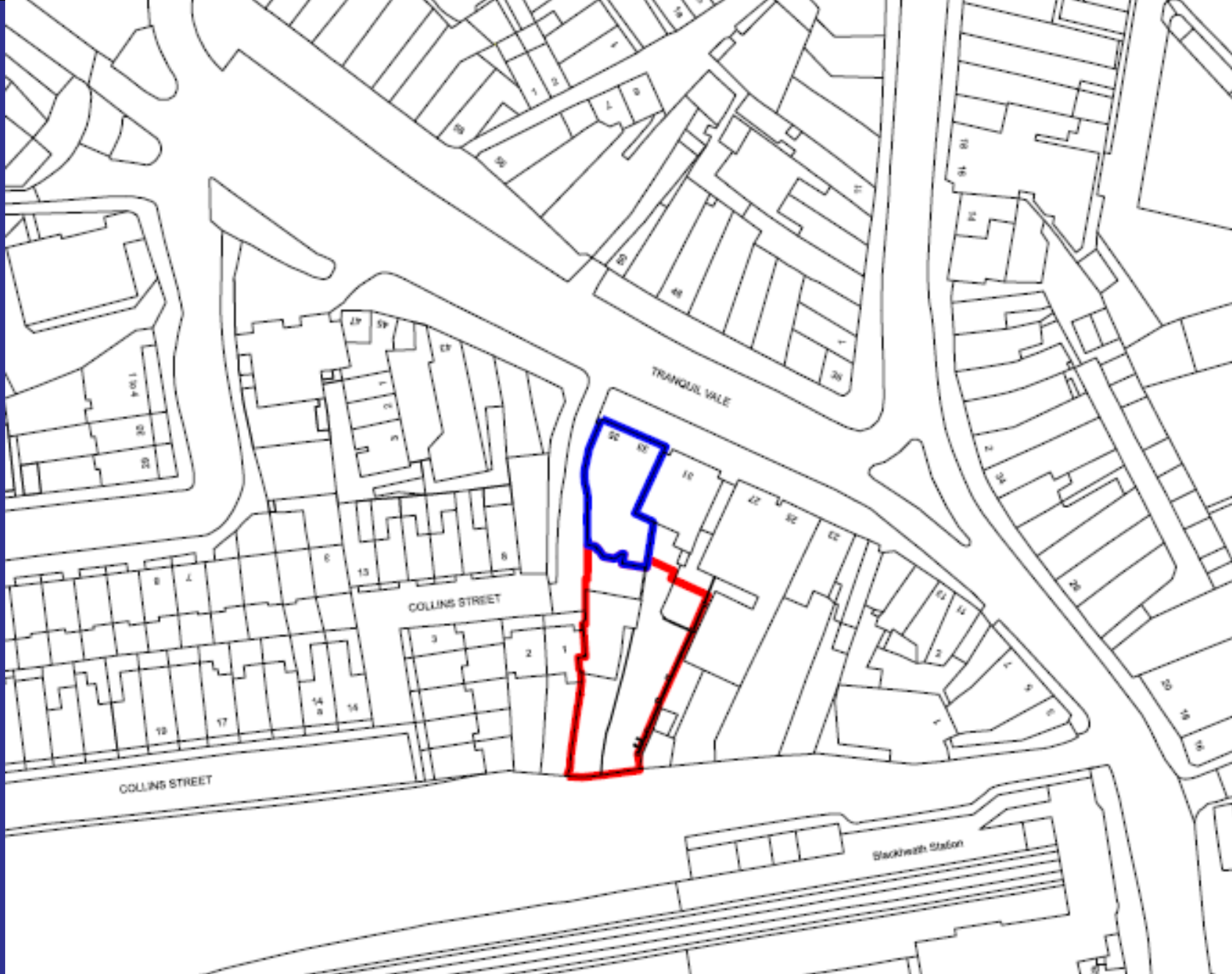

Site location



Blackheath Yoga





Proposed revised front area



Revised proposed soft and hard landscaping

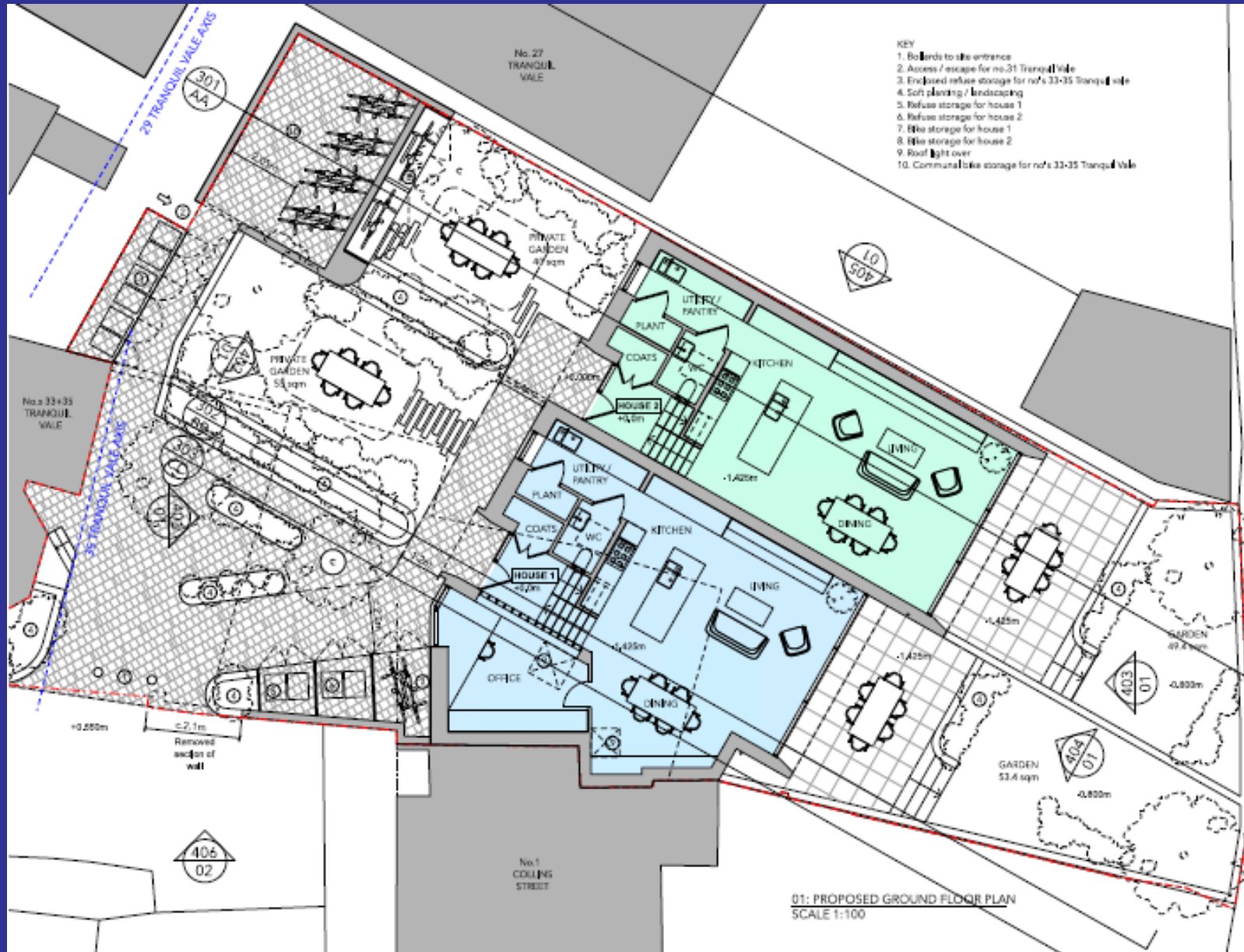

Proposed ground floor plan

Key material planning considerations:

- **Principle of the development**
- **Housing**
- **Urban Design and Impact on Heritage Assets**
- **Transport and Highways**
- **Impact on Living Conditions of Neighbours**
- **Sustainable Development**
- **Natural Environment**

THE END

